

ЗАГОРЬЕ

VISUALIZATION KUNTSEVSKAYA



REALIZATION KUNTSEVSKAYA



VISUALIZATION ST.M. SHEREMETYEVSAYA (MARINA ROSCHA)

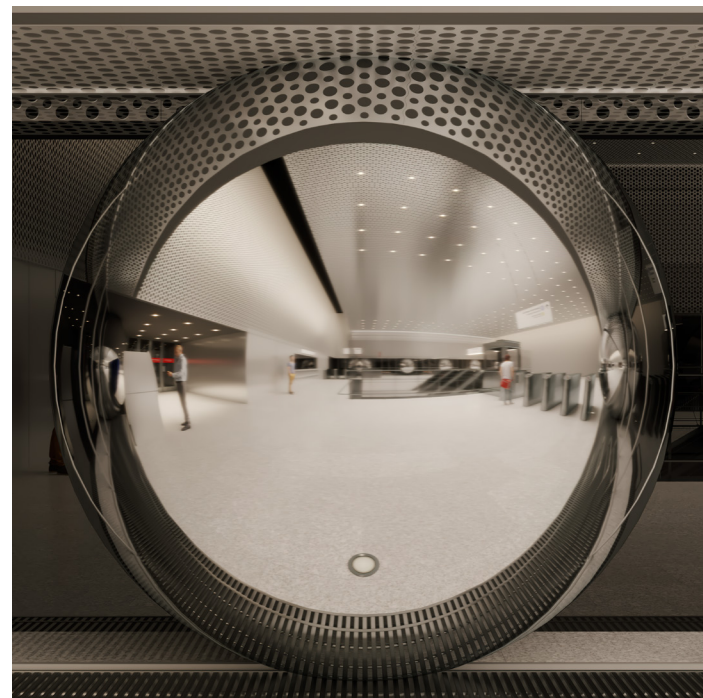

REALIZATION ST.M. SHEREMETYEVSAYA (MARINA ROSCHA)



METRO EXPERIENCE

PROSPECT VERNADSKOGO



MICHURINSKY PROSPEKT



TROPAREVO



RAMENKI





Zagorje has historically been a hilly forested region. The concept of finishing the metro station recreates a soft immersion through a thick haze of fog, which brings you closer to the nature of the forest edge and moves you into the freshness of the environment.

The transmission of the atmosphere of nature is carried out using a gradient layout of metal panels, of varying degrees of haze.

Visually, the fog will be expressed by the transition from a matte «sfumato» to a glossy reflection.



PLATFORM HALL



Using gradient panels, we achieve the effect of illusion in space, the boundaries of the ceiling disappear, there are no clear boundaries near the walls, thus we expand the space



PLATFORM HALL

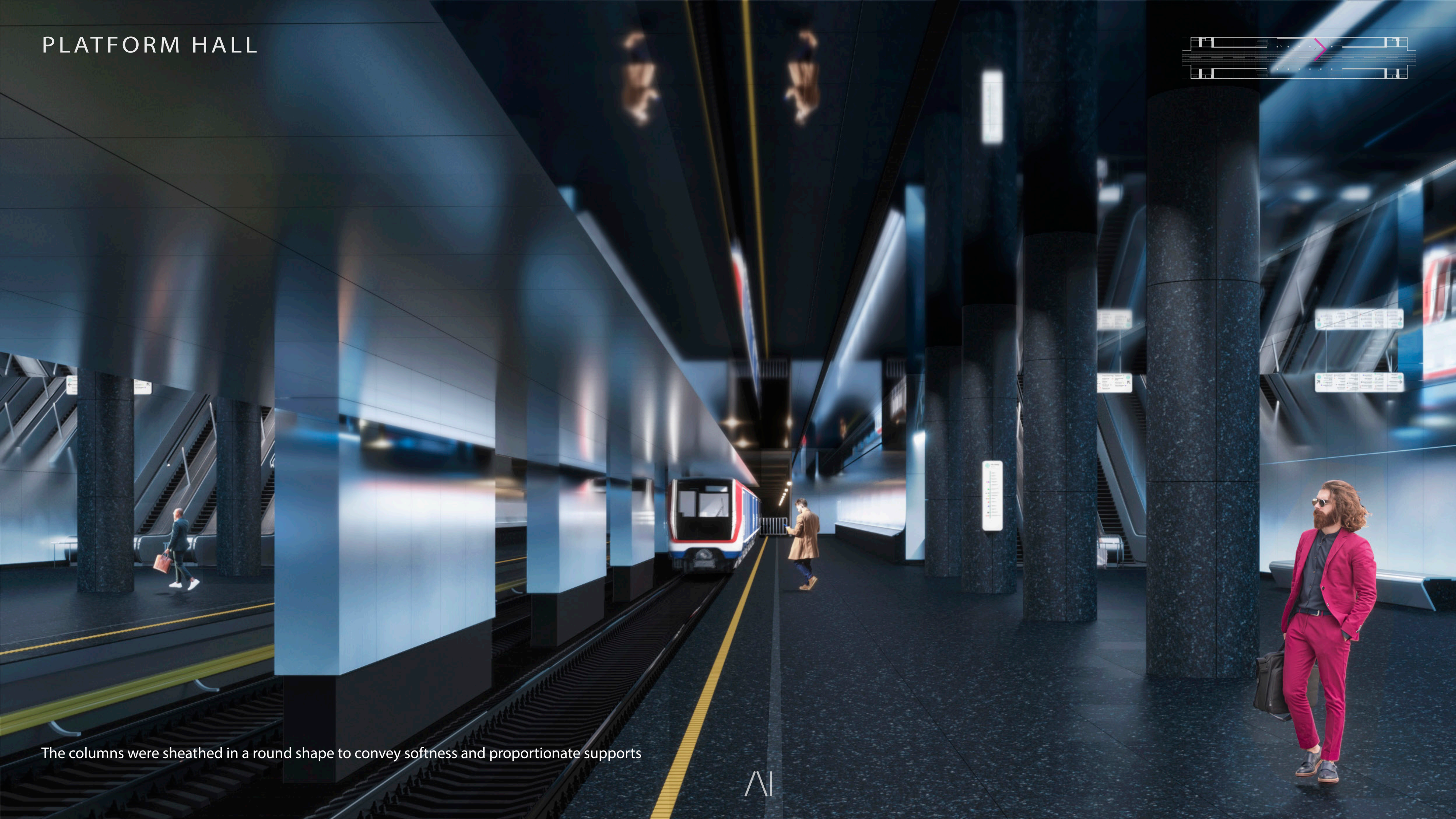

The columns were sheathed in a round shape to convey softness and proportionate supports





The concept solves the issue of surface finish glare to ensure traffic safety, a good view of the driver. The driver sees only matte surfaces, which contributes to a comfortable stay at the station

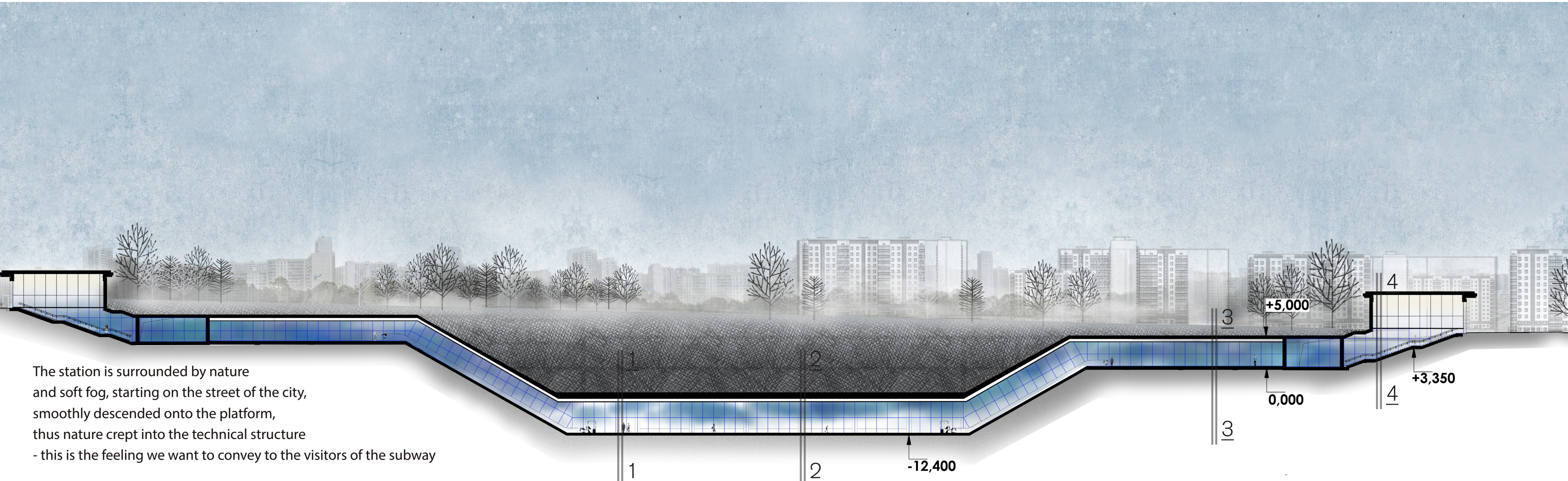

The station is surrounded by nature and soft fog, starting on the street of the city, smoothly descended onto the platform, thus nature crept into the technical structure - this is the feeling we want to convey to the visitors of the subway

1-1

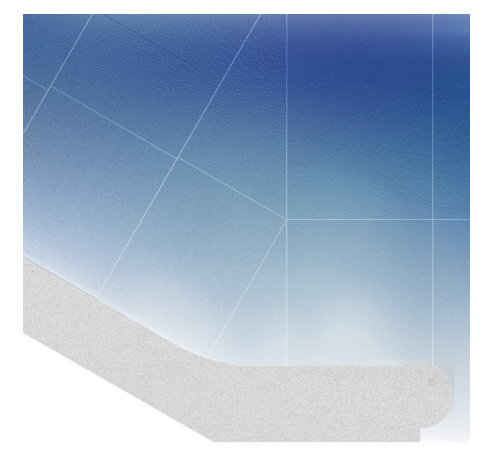

2-2

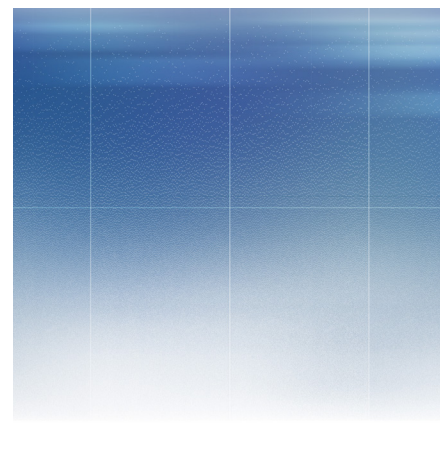

3-3

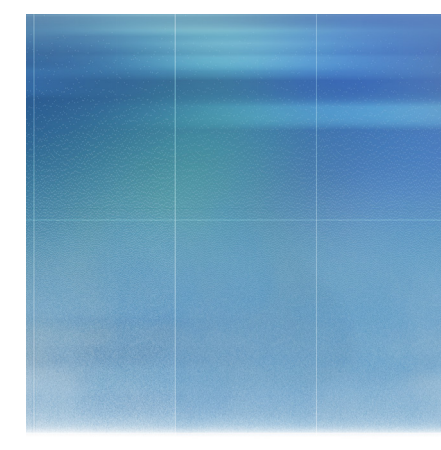

4-4

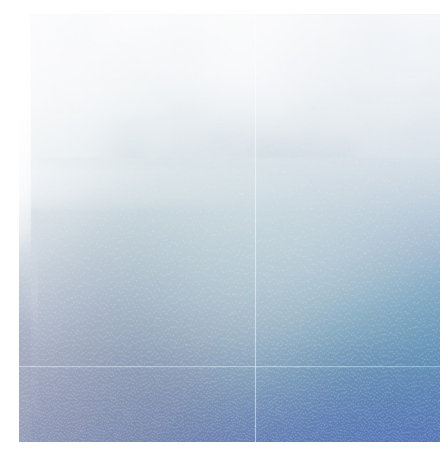

AI

Я

С

ЗАГОРЬЕ

К

To accurately convey naturalness and picturesqueness,
the name of the station used the font of the illustrator,
V.Favorsky.

The font plunges into the nature of Russian fairy tales.
The inscription is made with a light gradient,
the letters gradually emerge from the mist.

Ъ

Л

ЗАГОРЪЕ



The gradient is done by a transition from a heavily sanded panel to a panel with a mirror surface. We create a feeling of freshness and softness of the forest air



PLATFORM HALL ESCALATORS

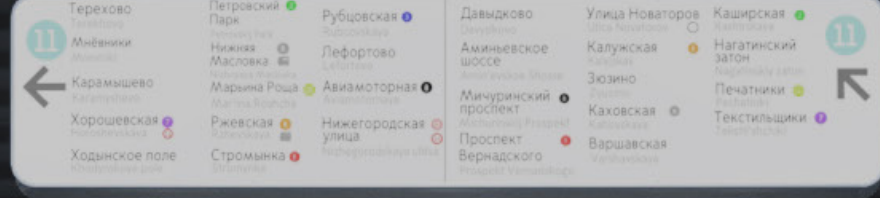

LOBBY - CASH HALL



Due to the active dynamics, different visual and light patterns are always smoothly replaced on the panels, reminiscent of the motifs of nature



LOBBY - TURNSTILES

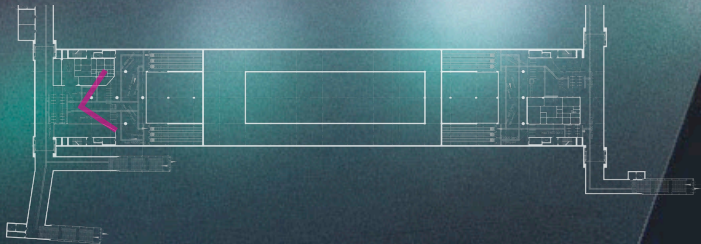

Ticket Office

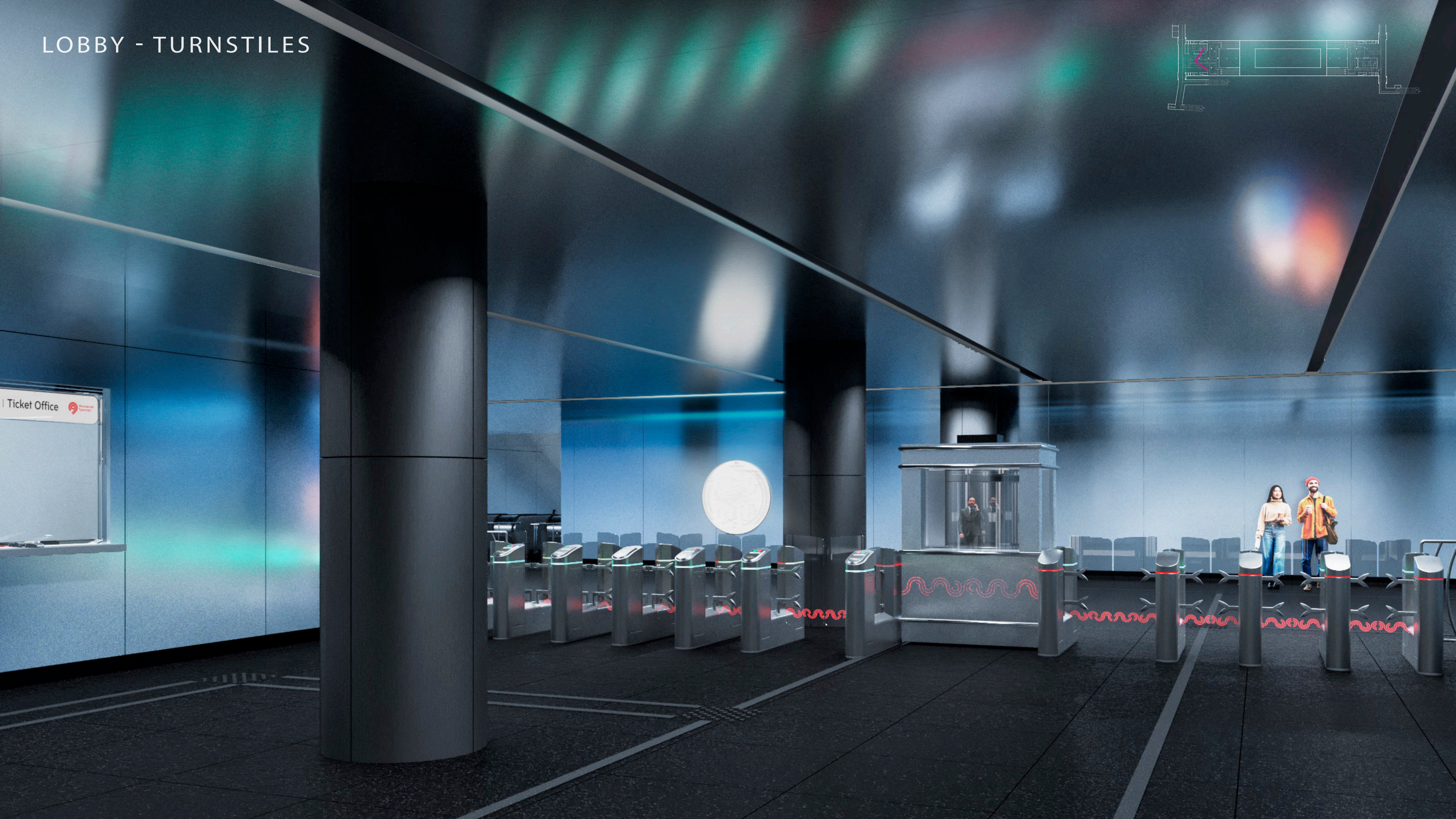

UNDERGROUND CROSSING- LOBBY ENTRANCE



